

QTY. OFF	MARK	PROFILE	LENGTH
4	2FB25-4	PFC150*75	1408

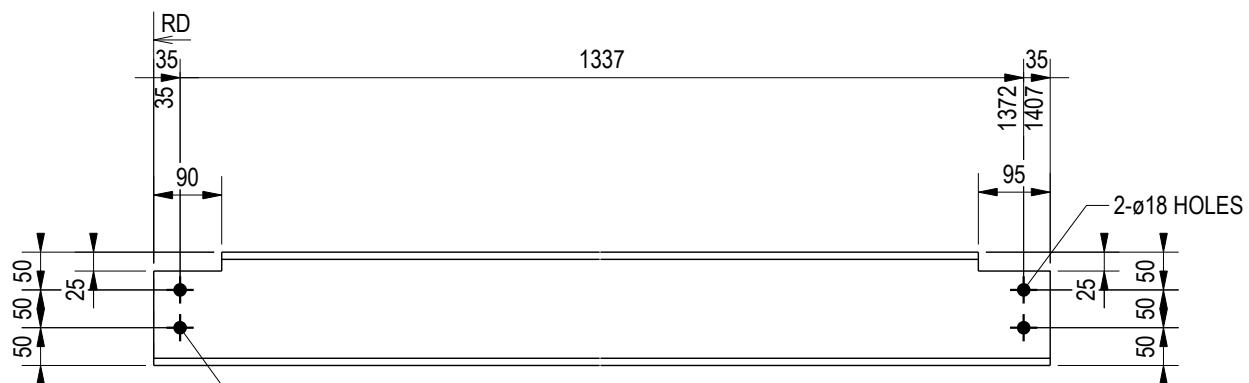

QTY. OFF	MARK	PROFILE	LENGTH
1	2FB25-5	PFC150*75	1407

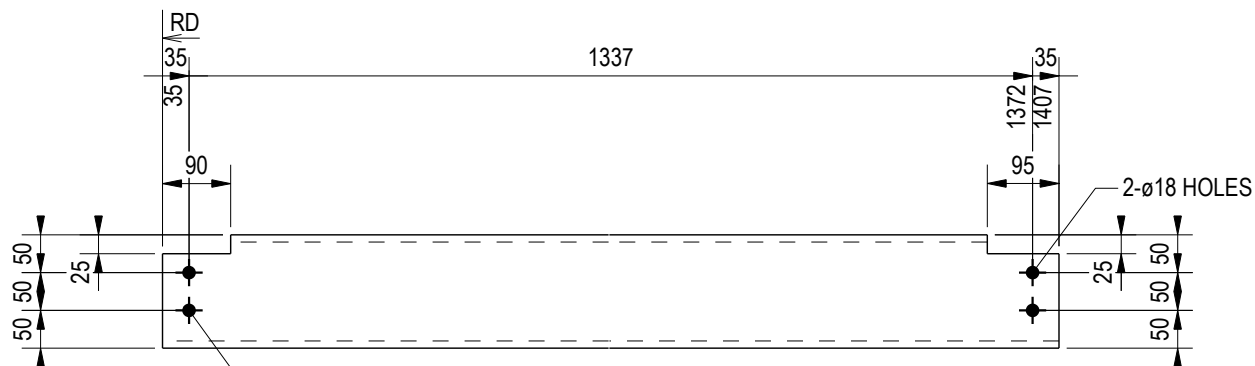

QTY. OFF	MARK	PROFILE	LENGTH
1	2FB25-6	PFC150*75	1407

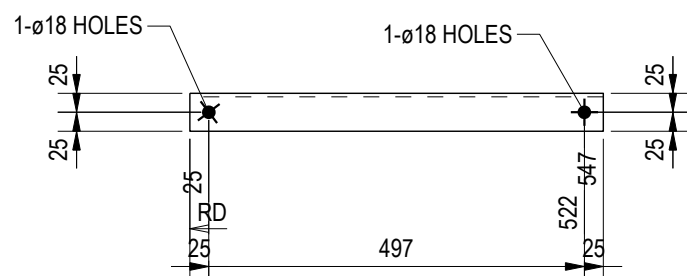

QTY. OFF	MARK	PROFILE	LENGTH
1	2KB1-3	EA50*50*5	547

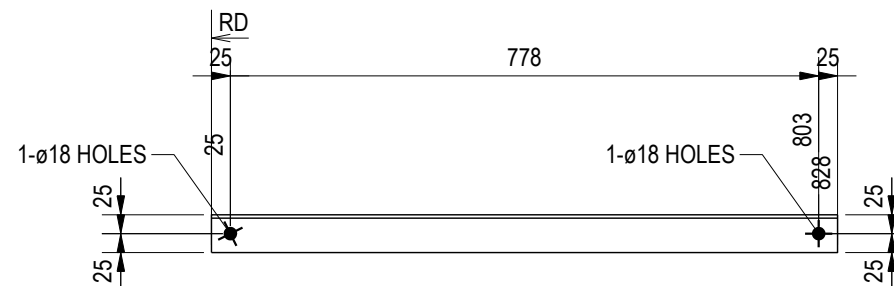

QTY. OFF	MARK	PROFILE	LENGTH
3	2KB1-1	EA50*50*5	828

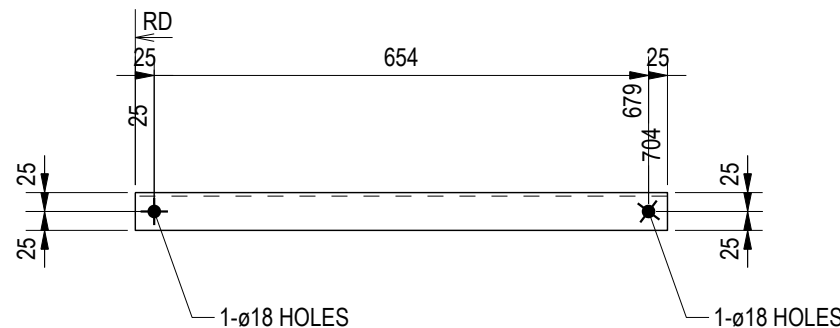

QTY. OFF	MARK	PROFILE	LENGTH
7	2KB1-2	EA50*50*5	704

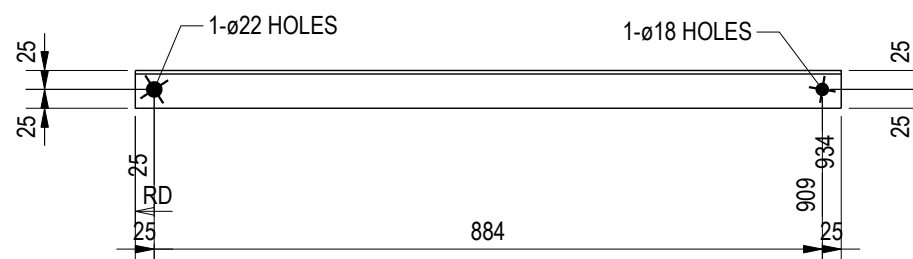

QTY. OFF	MARK	PROFILE	LENGTH
1	2KB2-1	EA50*50*5	934

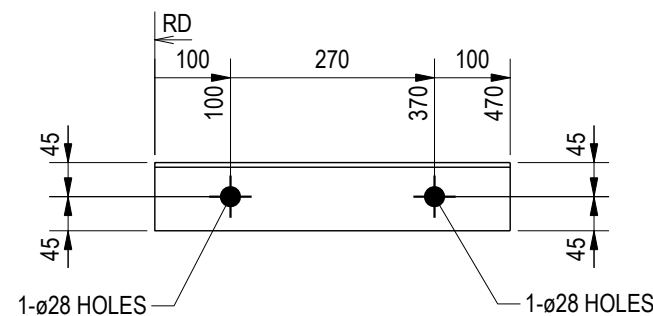

QTY. OFF	MARK	PROFILE	LENGTH
3	2RA3-8	EA90*90*6	470

**General Notes:**

1. ALL WELDS ARE 6CFW U.N.O.
2. FINISH - PRIMED U.N.O.
3. CONTACT NIP DETAILING FOR ANY DISCREPANCIES
4. DO NOT SCALE DRAWING
5. CONTRACTOR TO VERIFY ALL LEVELS AND DIM'S PRIOR TO COMMENCEMENT WORK ON SITE OR ANY FABRICATION

Orientation marks are placed according to the rules:

- to the top flange of beams, at the end which points closest to the north or east
- to the lower end of columns, on the flange which points closest to the north or east
- to the flange of bracing, at the end which points closest to the north or east

REV	DATE	DESCRIPTION	PROJECT NAME	
		CLIENT		
		PROJECT No	ISSUE DATE	18.07.2014
		DRAWN BY	Eng. RADU GORAN	DRAWING No
		CHECKED BY		REV
		APPROVED BY		SCALE
			<b>SD 362</b>	NTS



P: (0040) 742 770 705

www.nip-detailing.com



3rd angle projection

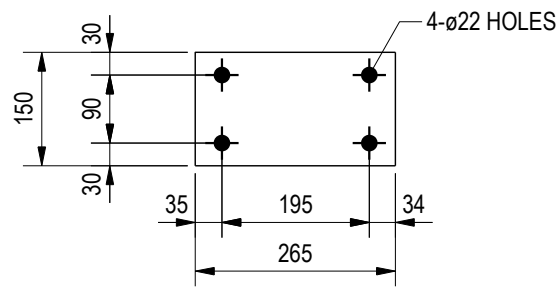

QTY. OFF	MARK	PROFILE	LENGTH
2	2P-34	FLAT10*150	265

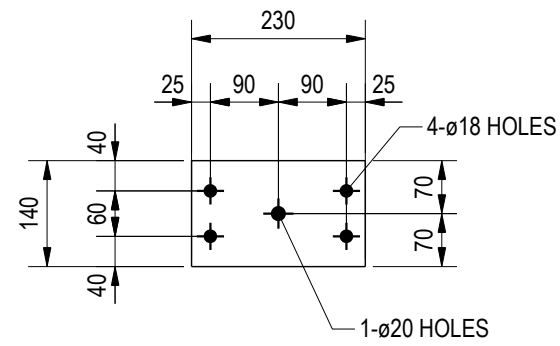

QTY. OFF	MARK	PROFILE	LENGTH
1	2P-40	PLATE10*140	230

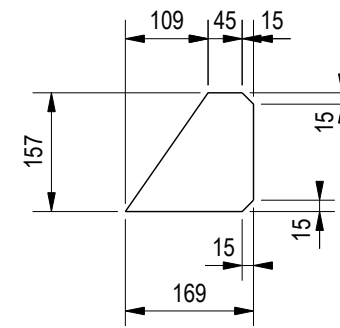

QTY. OFF	MARK	PROFILE	LENGTH
4	2P-44	PLATE10*157	169

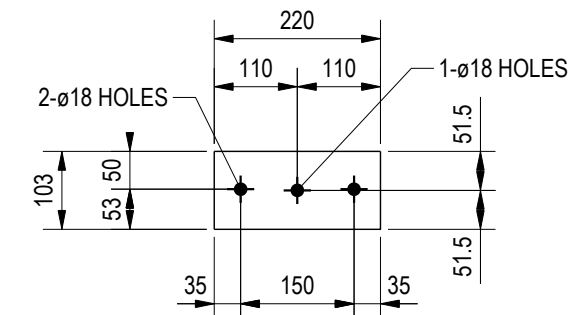

QTY. OFF	MARK	PROFILE	LENGTH
1	2P-36	PLATE10*103	220

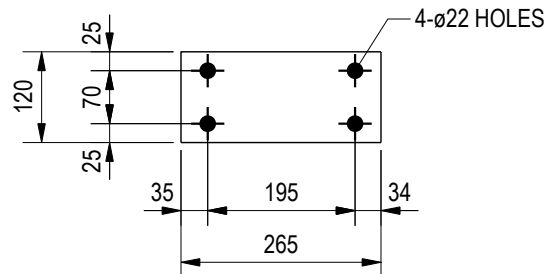

QTY. OFF	MARK	PROFILE	LENGTH
4	2P-35	PLATE10*120	265

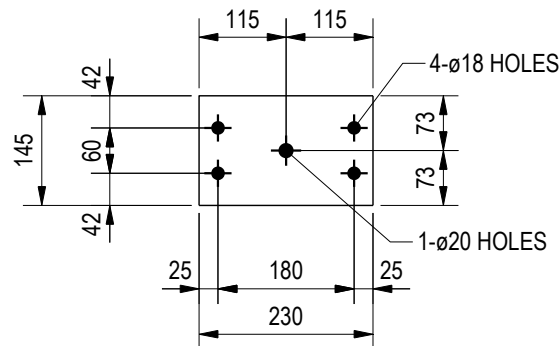

QTY. OFF	MARK	PROFILE	LENGTH
1	2P-41	PLATE10*145	230

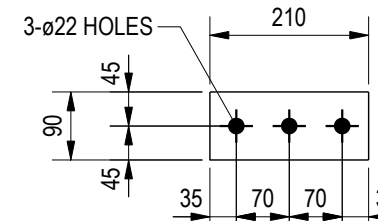

QTY. OFF	MARK	PROFILE	LENGTH
11	2P-45	FLAT10*90	210

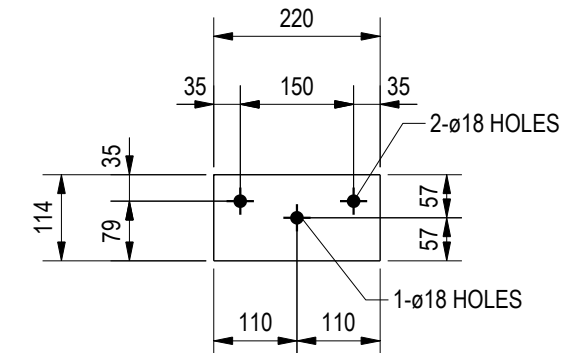

QTY. OFF	MARK	PROFILE	LENGTH
2	2P-38	PLATE10*114	220

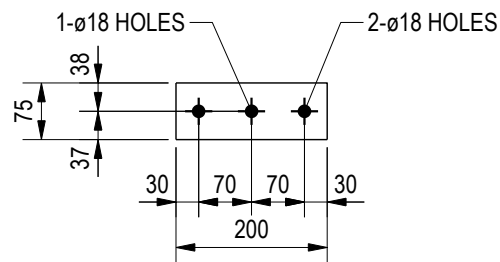

QTY. OFF	MARK	PROFILE	LENGTH
18	2P-37	FLAT10*75	200

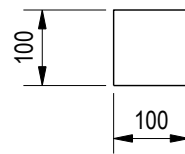

QTY. OFF	MARK	PROFILE	LENGTH
10	2P-42	FLAT10*100	100

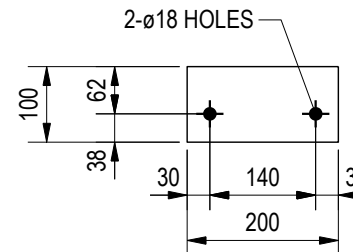

QTY. OFF	MARK	PROFILE	LENGTH
4	2P-46	FLAT10*100	200

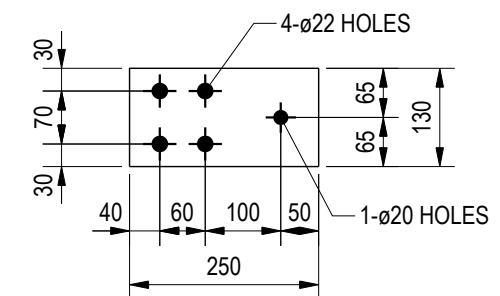

QTY. OFF	MARK	PROFILE	LENGTH
1	2P-47	FLAT10*130	250

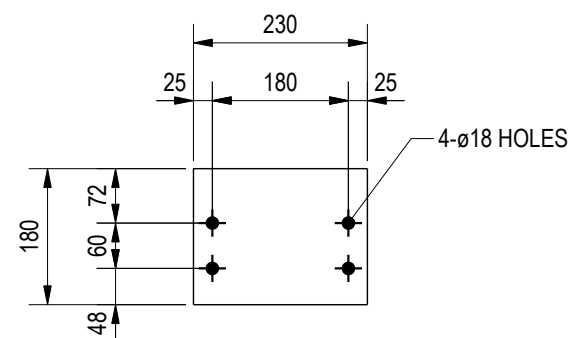

QTY. OFF	MARK	PROFILE	LENGTH
10	2P-39	FLAT10*180	230

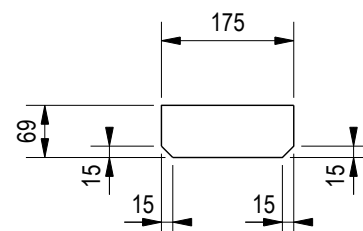

QTY. OFF	MARK	PROFILE	LENGTH
12	2P-43	PLATE10*69	175

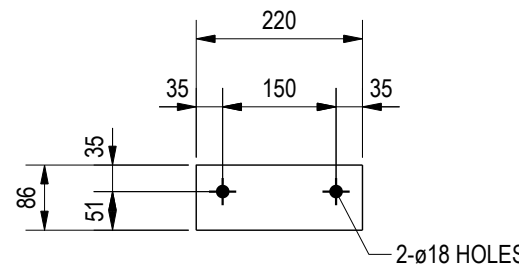

QTY. OFF	MARK	PROFILE	LENGTH
2	2P-48	PLATE10*86	220

**General Notes:**

1. ALL WELDS ARE 6CFW U.N.O.
2. FINISH - PRIMED U.N.O.
3. CONTACT NIP DETAILING FOR ANY DISCREPANCIES
4. DO NOT SCALE DRAWING
5. CONTRACTOR TO VERIFY ALL LEVELS AND DIM'S PRIOR TO COMMENCEMENT WORK ON SITE OR ANY FABRICATION

Orientation marks are placed according to the rules:

- to the top flange of beams, at the end which points closest to the north or east
- to the lower end of columns, on the flange which points closest to the north or east
- to the flange of bracing, at the end which points closest to the north or east

REV	DATE	DESCRIPTION		
		CLIENT	PROJECT NAME	
		PROJECT No	ISSUE DATE	23.07.2014
		DRAWN BY	Eng. RADU GORAN	DRAWING No
		CHECKED BY		REV
		APPROVED BY		SCALE
			<b>SD 416</b>	NTS

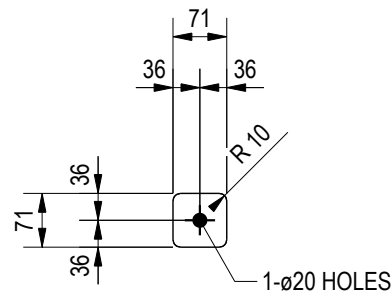

QTY. OFF	MARK	PROFILE	LENGTH
46	2P-67	PLATE6*71	71

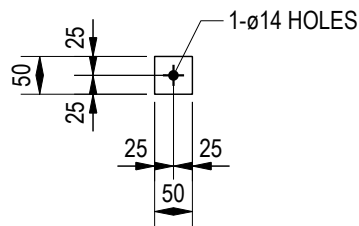

QTY. OFF	MARK	PROFILE	LENGTH
20	2P-68	FLAT6*50	50

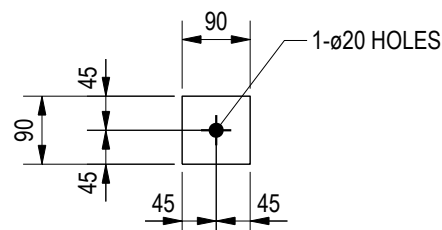

QTY. OFF	MARK	PROFILE	LENGTH
1	2P-69	FLAT6*90	90

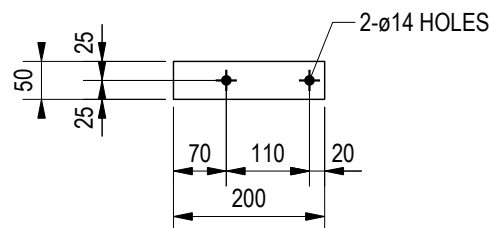

QTY. OFF	MARK	PROFILE	LENGTH
18	2P-70	FLAT6*50	200

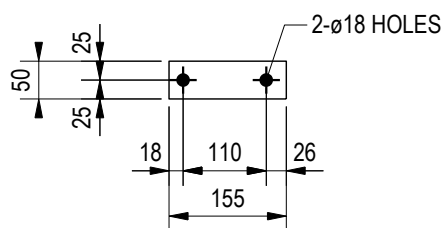

QTY. OFF	MARK	PROFILE	LENGTH
14	2P-71	FLAT6*50	155

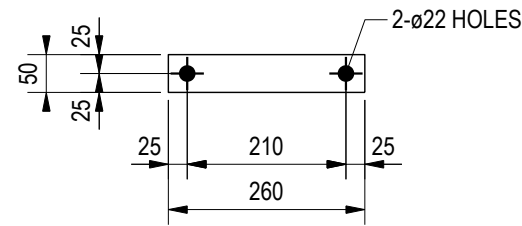

QTY. OFF	MARK	PROFILE	LENGTH
14	2P-72	FLAT6*50	260

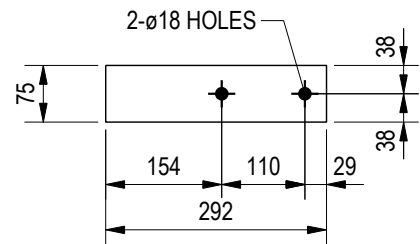

QTY. OFF	MARK	PROFILE	LENGTH
192	2P-74	FLAT8*75	292

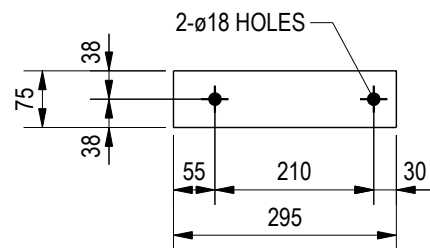

QTY. OFF	MARK	PROFILE	LENGTH
296	2P-75	FLAT10*75	295

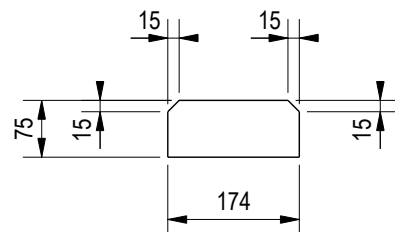

QTY. OFF	MARK	PROFILE	LENGTH
50	2P-76	FLAT10*75	174

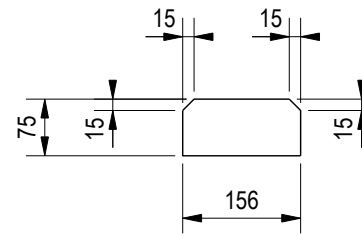

QTY. OFF	MARK	PROFILE	LENGTH
6	2P-77	FLAT10*75	156

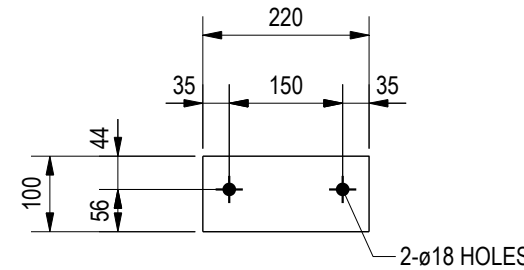

QTY. OFF	MARK	PROFILE	LENGTH
8	2P-78	FLAT10*100	220

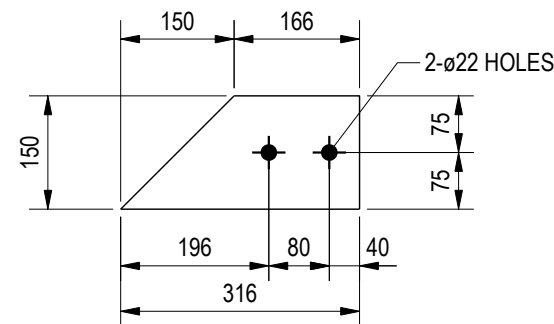

QTY. OFF	MARK	PROFILE	LENGTH
10	2P-80	FLAT10*150	316

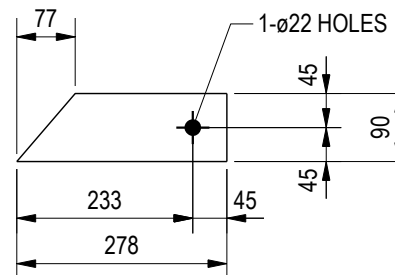

QTY. OFF	MARK	PROFILE	LENGTH
2	2P-81	FLAT12*90	278

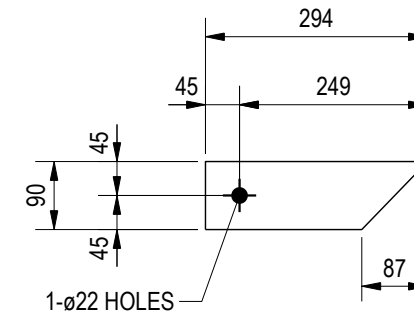

QTY. OFF	MARK	PROFILE	LENGTH
2	2P-82	FLAT12*90	294

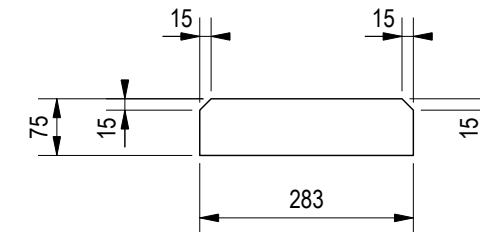

QTY. OFF	MARK	PROFILE	LENGTH
1	2P-84	FLAT10*75	283

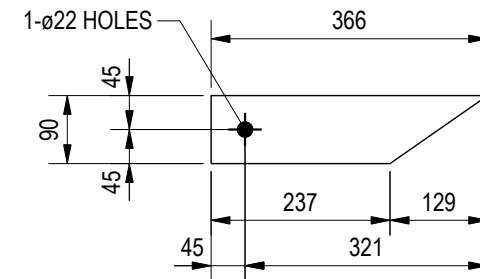

QTY. OFF	MARK	PROFILE	LENGTH
6	2P-65	FLAT12*90	366

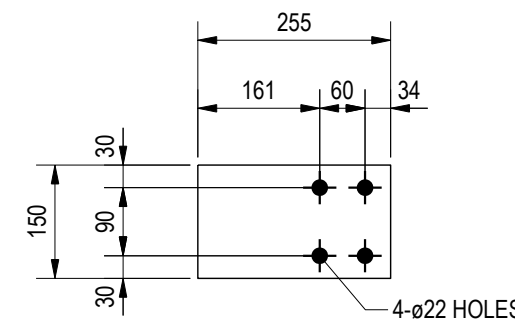

QTY. OFF	MARK	PROFILE	LENGTH
7	2P-66	FLAT12*150	255

**General Notes:**

- ALL WELDS ARE 6CFW U.N.O.
  - FINISH - PRIMED U.N.O.
  - CONTACT NIP DETAILING FOR ANY DISCREPANCIES
  - DO NOT SCALE DRAWING
  - CONTRACTOR TO VERIFY ALL LEVELS AND DIMS PRIOR TO COMMENCEMENT WORK ON SITE OR ANY FABRICATION
- Orientation marks are placed according to the rules:
- to the top flange of beams, at the end which points closest to the north or east
  - to the lower end of columns, on the flange which points closest to the north or east
  - to the flange of bracing, at the end which points closest to the north or east

REV	DATE	DESCRIPTION	PROJECT NAME	
		CLIENT		
		PROJECT No	ISSUE DATE	23.07.2014
		DRAWN BY	Eng. RADU GORAN	DRAWING No
		CHECKED BY		REV
		APPROVED BY		SCALE
			<b>SD 418</b>	NTS